

Duct Assembly Installation

Imperial

Assembling Duct

NOTE:
Takes (2) pieces to
make (1) length of duct.
(Pieces sold individually)

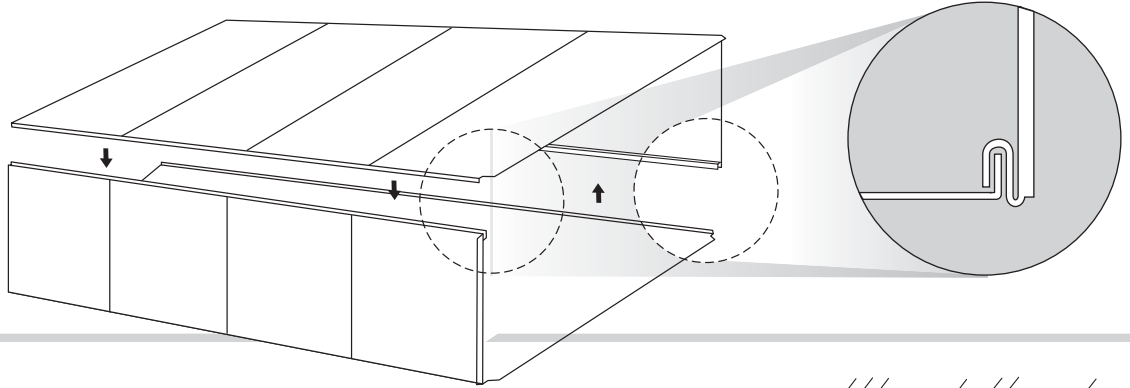

Connecting Two Lengths of Duct Using Cleats

S-cleat

Drive Cleat

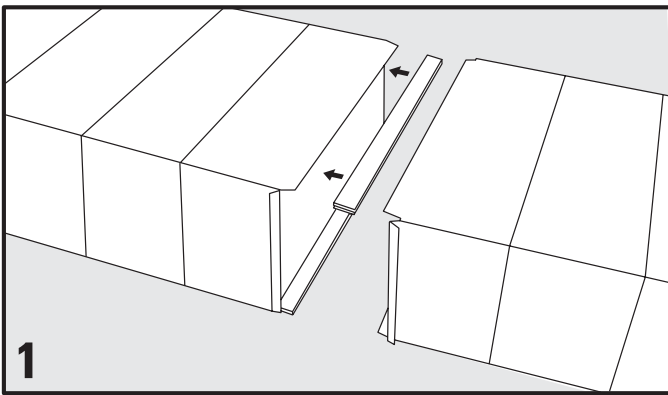
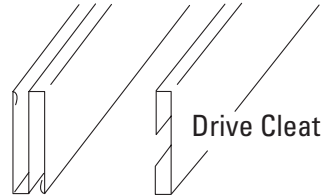

1
S-cleats are used to connect two lengths of duct together.

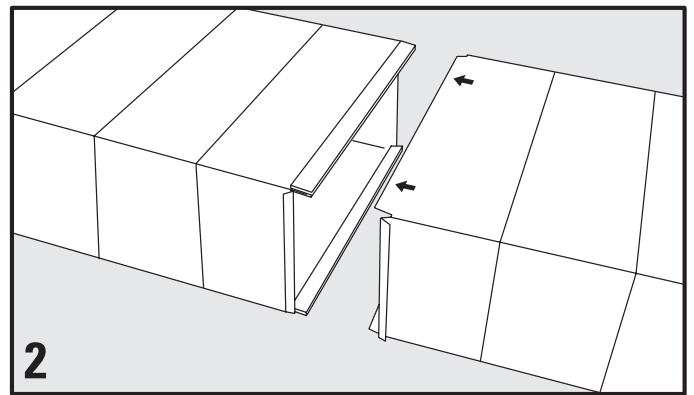

2
Slide a S-cleat onto the upper and lower end of the first length of duct.

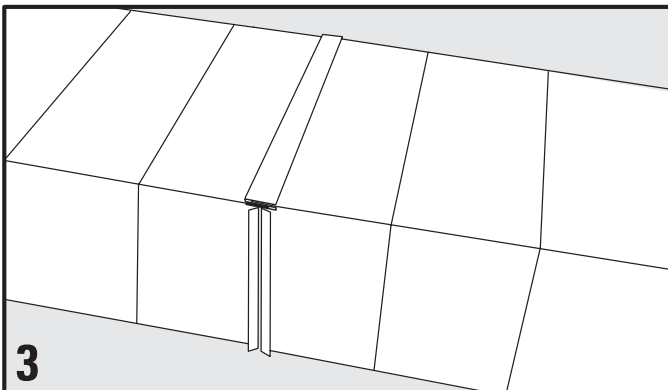

3
Connect the second length of duct to the first by sliding its upper and lower ends into the S-cleats.

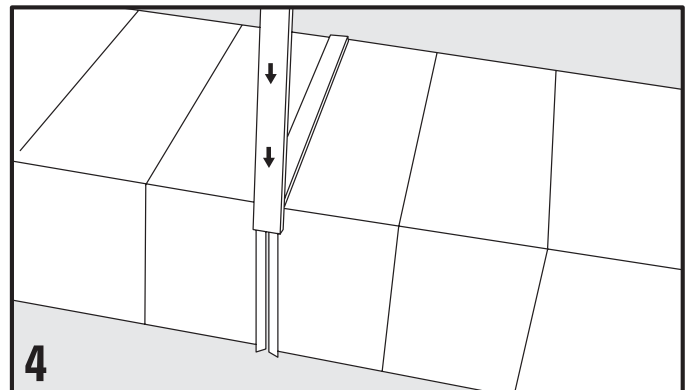

4
Slide a Drive Cleat into the channel on the side of the duct. Repeat on opposite side.

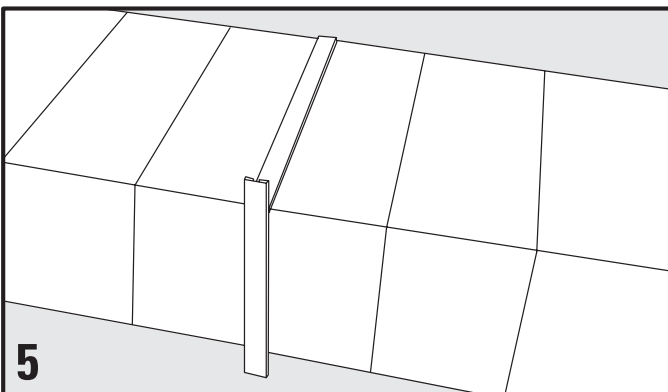

5
Align the Drive Cleat so that its ends extend beyond the duct.

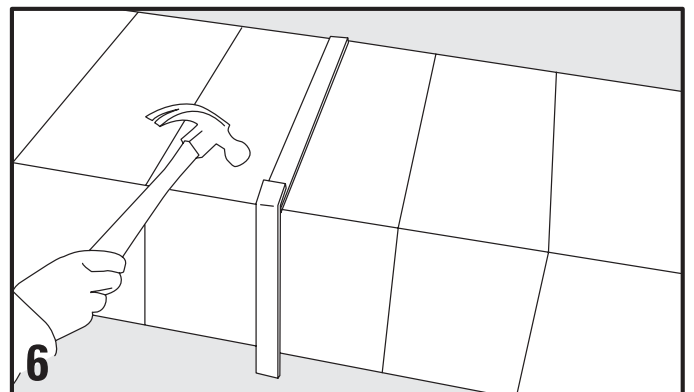

6
Using a hammer, bend its ends so that they lay flat against the duct. Repeat on opposite side.



Imperial
Manufacturing Group™

For more information on these and other quality products
manufactured by Imperial, please contact:

Imperial Manufacturing Group
40 Industrial Park Street
Richibucto, NB E4W 4A4

Tel: 1 800 561 3100
Fax: (506) 523-9024
www.imperialgroup.ca



Other Manufacturing Facilities, Sales Offices & Distribution Centres:
Richibucto, NB | Dieppe, NB | Anjou, QC | Montreal, QC | Oakville, ON | Hamel, IL | Dartmouth, NS

**GALVANIZED
DUCT, PIPE & FITTINGS
Installation Tips**